



Goa Institute of Management

The Learning Never Stops



BROCHURE 2025

- ▲ PGDM
- ▲ PGDM-HEALTHCARE MANAGEMENT
- ▲ PGDM-BIG DATA ANALYTICS
- ▲ PGDM-BANKING, INSURANCE AND FINANCIAL SERVICES
- ▲ INTERNATIONAL DOUBLE DEGREE IN ANALYTICS

Accreditations, Memberships and Accolades

Approved by



All India Council for Technical Education (AICTE)

Recognized by



Association of Indian Universities (AIU)

Accredited by



- 2022 -



BUSINESS GRADUATES ASSOCIATION

- 2022 -



PGDM | BDA | HCM



- 2018 -

Member of



The Association to Advance Collegiate Schools of Business (AACSB)



European Foundation for Management Development (EFMD)

PRME Principles for Responsible Management Education

an initiative of the 

Principles for Responsible Management Education (PRME), a United Nations - backed effort.

- Champions for 2023 & 2024



Global Business School Network



United Nations Sustainable Development Solutions Network



Network India

UN-Global Compact Network India



Consortium of Universities for Global Health



Ranked **37th** by National Institutional Ranking Framework



Ranked Top Level 5 'Pioneering' in PIR in 2021 & 2023



GIM Students have won the awards in 2021 - SDG 8, 2022 - SDG 6, 2023 - SDG 10 & 2024 - SDG 5 & SDG 17



Sustainability Institute of the Year 2022

**30 +
Years
of Academic
Excellence**

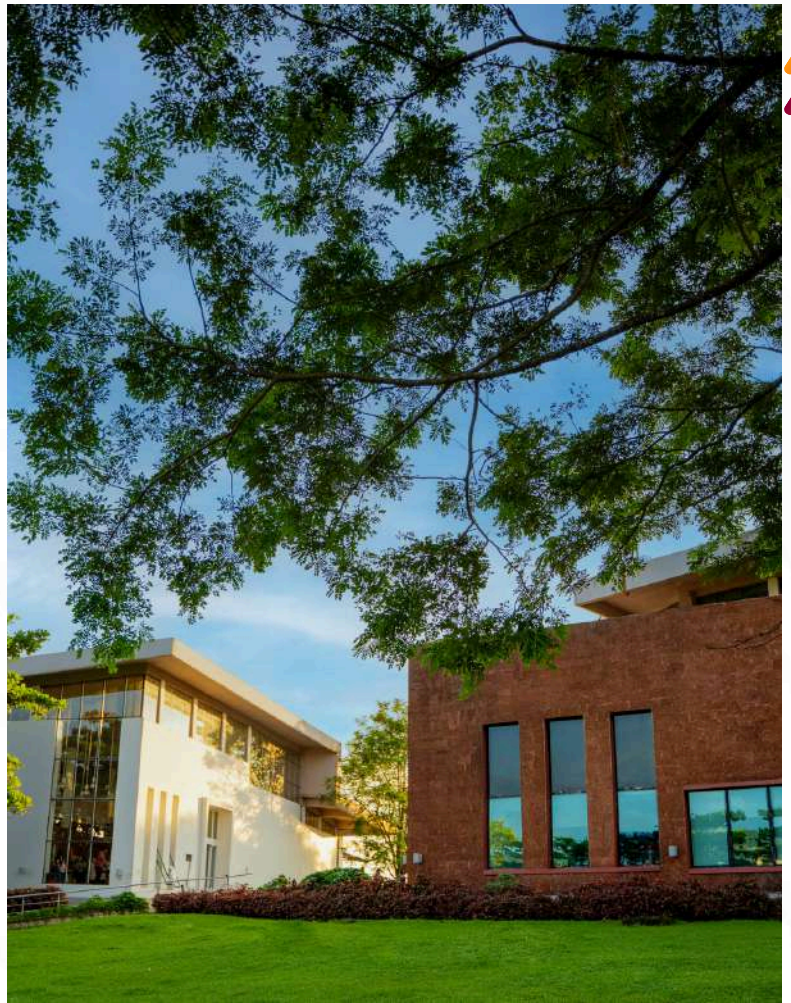

About GIM

GIM prepares students to be responsive and responsible leaders, making a difference in society. We offer five two-year full-time PGDM programs, including PGDM, PGDM-Healthcare Management, PGDM-Big Data Analytics, PGDM-Banking, Insurance and Financial Services and International Double Degree in Analytics with Nova SBE, Portugal. We also offer the Fellow Program in Management and a Hybrid Program for working executives. We have a 50 acre scenic campus with opportunities for outdoor learning, creativity through theatre, sports and simulation games. GIM is approved by AICTE and focuses on diversity, pedagogy and curriculum. Our students learn from peer interaction and informal communication with faculty, as well as managing activities in the Institute. We have a strong alumni network and consistently break our placement records. Our faculty is highly qualified and experienced, many from the industries. Students get opportunities to enrich their learning through participation in a diverse range of athletic and cultural activities.

▲ Vision

To be a preeminent business school at the forefront of management education and research. We will create transformative leaders focused on responsible, ethical and sustainable business practices.

▲ Mission

To create knowledge and develop responsible and agile leaders at the forefront of cutting-edge business practices.

Message from the Director

It is with immense pride that I present the Goa Institute of Management (GIM) as a leader in fostering lifelong learning and holistic excellence for our students, faculty, and the wider community. Our programs continue to thrive, with our graduates being highly sought after by industry leaders, even amidst challenging market conditions. This year, our students have raised the bar yet again with nearly 100 Pre-Placement Offers (PPOs). Remarkably, one-third of the students in our PGDM (BIFS) program received PPOs for the second consecutive year.

Despite global market uncertainties, our students have excelled across diverse sectors, with average salaries remaining strong compared to last year with the highest offer at an impressive ₹29 LPA, earned by a PGDM (HCM) student. These achievements underscore the relevance and strength of our programs, which continue to be recognized among the nation's premier offerings in both academic and corporate circles.

Additionally, the launch of the International Double Degree in Analytics (IDA) program last year has been a major milestone. This innovative program, in collaboration with the Nova School of Business and Economics, Portugal—one of Europe's top B-schools—provides our students with invaluable international exposure and expertise in data analytics.

GIM's global standing continues to grow, with prestigious international accolades further solidifying our reputation. We have recently completed the re-accreditation process of SAQS, a highly ranked accreditation body in South Asia, and we continue to hold the coveted AMBA and BGA accreditations, placing us among an elite group of B-schools in the country. Furthermore, our steadfast commitment to sustainability and social responsibility has been recognized by the Positive Impact Ranking (PIR) 2023, where we were listed under the 'Pioneering' category.

In terms of national rankings, GIM continues to be ranked among the top B-schools in the country, with an NIRF rank of 37.

We remain committed to expanding our focus on sustainability and social impact. One notable initiative has been the nationwide expansion of

our 'Service Learning and Rural Immersion' course, which saw over 100 projects executed across India, along with one international project. This initiative is a powerful step toward fulfilling our vision of "creating transformative leaders focused on responsible, ethical, and sustainable business practices."

Moreover, we are making significant strides in establishing a world-class research ecosystem. GIM actively supports faculty in developing intellectual capital through both teaching and research. Our faculty's research output has grown in both volume and impact, with over 100 high-quality journal articles, case studies, books, and book chapters published last year. Faculty members also presented numerous papers at national and international conferences, further elevating our academic profile.

In addition, GIM faculty have been engaged in a variety of sponsored research projects in collaboration with esteemed organizations such as the Alliance for Health Policy & Systems Research (WHO), the Arts and Humanities Research Council (UK), ERIA-Monash University, and CSSR-JSPS (Japan Government), among others.

As GIM continues to evolve, we remain dedicated to nurturing transformative leaders equipped with the skills, values, and vision to drive responsible and sustainable business practices globally.

▲ **Dr. Ajit Parulekar**

Director, Goa Institute of Management



GIM Journey



1993

Foundation of the Institute with first batch of 24 students



1994

Institute moves to the heritage building at Ribandar near Panjim



1995

Student intake increased to 120 per batch



2000

GIM introduces Part-Time MBA for working executives



2009

Foundation laid for new 50 acre campus at Sanquelim, North Goa



2010

Moved to a new sprawling campus at Sanquelim



2013

Launched 2-year full time PGDM in Healthcare Management



2018

Launched 2-year full time PGDM in Big Data Analysis Launch of Atal Incubation Center at GIM



2019

Student intake of PGDM (BDA) increased to 120



2020

Launched 2-year full time PGDM in Banking Insurance & Financial Services & Fellow Program in Management



2021

Rated among the top four B-schools globally in Positive Impact Rating (PIR) Edition 2021



2022

GIM rolls out PGDM (Hybrid) for working executives



2023

International Double Degree Programme in Analytics with NOVA SBE, Portugal

Highlights

1st

Indian Business School to be listed on the Haub SDG Dashboard
(St. Joseph's University, USA)

2023

Top Big Data Analytics Program

in India by AIM (Analytics India Magazine)

70+

Ph.D. professors on campus

175+

Reputed Companies Recruited from GIM

85+

Full-Time Faculty

400+

Give Goa Projects in the last four years

50+

Acres of Scenic Campus

30+

Years of Academic Excellence

Top 10

Healthcare Management Institutes in India 2021: Higher Education Review

2%

Amongst top 2% of globally ranked B-Schools by AMBA

Solar Plant on Campus Generates

745kw

of Solar Power

#37

NIRF Ranking 2024 by Govt. of India

2023 Champion PRME (Principles for Responsible Management Education)

22

Students studying from across States in India

5L

in Merit Scholarships per student for selected upto 80 students

Top 11

Private Business Schools by Outlook India ranked "Top Private MBA Institutions In India" of 2022

2nd

Institute in India to be
awarded BGA Accreditation



80+ Student events
across the year

6500+ Strong
Alumni Base

12:1 Student Faculty Ratio

Ranked

"Best for the World"

Pioneering B-School in Positive
Impact Ratings globally



Partnerships with
SAS 26

Skill Enhancing
Student Clubs

5

Centers of
Excellence



Bloomberg Finance Lab, Behavioral
Science Lab & Data Analytics Lab
offers students the most powerful
technology platforms



**Atal
Incubation
Center**



for promoting Entrepreneurship & Start-ups

Ranked among the

Top 15

Private Business Schools

in India by leading ranking surveys

16

Collaborations and Exchanges
with International Universities

Our Full-Time Programmes

Goa Institute of Management offers PGDM programs that nurture intellectual growth, boost career prospects, and empower students for real-world challenges, making them valuable assets for businesses and society



01 Post Graduate Diploma in Management (PGDM)

GIM's PGDM blends theory and practice to educate future leaders. The program covers various management domains, with a mix of core and elective courses, a social project, Summer Internship Project, and opportunities for student exchange and independent study. The program also offers a chance to gain practical experience through global partner institutions.

02 PGDM - Healthcare Management (HCM)

GIM's PGDM in Healthcare Management trains future leaders for growth in the healthcare industry. The program combines management and healthcare courses and includes initiatives like Know Your Healthcare Provider and other social projects. With increased demand for healthcare management professionals, the program offers lucrative career opportunities. The six-term curriculum is designed to meet industry needs and includes core and elective courses, with focus on cultural sensitivity in healthcare contexts.

03 PGDM - Big Data Analytics (BDA)

GIM's Big Data Analytics program prepares future-ready managers with a blend of technical skills and managerial knowledge. The two-year full-time PGDM program balances business knowledge with hands-on experience and a five-month industry internship. The curriculum is validated by a board of studies and features guest lectures and practical projects in a real business environment. It is designed to meet the growing demand for data-driven decision making in management.

04 PGDM - Banking, Insurance & Financial Services (BIFS)

The PGDM BIFS is a 2-year full-time program with 6 terms, closely tied to organizational collaborations with 20 banks and financial firms. Industry execs lead a portion of the courses. A key aspect of the program is industry partners providing extended internships, guidance, and mentoring to students. This leads to better job readiness and recruitment opportunities for students and stronger career prospects for graduates. The program includes a 4-5-month internship for more corporate exposure.

05 International Double Degree in Analytics (IDA)

PGDM - BDA, GIM + Masters in Business Analytics, Nova School of Business and Economics, Portugal) is for aspirants who are passionate about unraveling insights from diverse data and aspire to lead data-driven organizations, enhance decision-making, and tackle managerial challenges. It offers an international, experiential learning opportunity for future leaders keen on data-driven transformation, addressing managerial complexities, and mastering data ethics.



PGDM Placements

26.3 LPA
▲ Highest CTC

14.81 LPA
▲ Average CTC

14.6 LPA
▲ Median CTC

20.7 LPA
▲ Top 20 Students

18.6 LPA
▲ Top 50 Students

16.7 LPA
▲ Top 100 Students



▲ Top Recruiters



PGDM - HCM Placements

29 LPA
▲ Highest CTC

14.25 LPA
▲ Average CTC

13 LPA
▲ Median CTC

26.5 LPA
▲ Top 10% Students

21.5 LPA
▲ Top 20% Students

16.7 LPA
▲ Top 50% Students

▲ Top Recruiters

PHILIPS

stryker

Johnson & Johnson

 ZIMMER BIOMET

 **Dr. Lal Path Labs**
India's leading and most reputed diagnostic chain

 **sagility**

bioradmedisys
science for people

Syneos
Health

digit
LIFE INSURANCE

LEK[™]

zydus
Dedicated To Life

HCL

 **FRESENIUS**
MEDICAL CARE

Deloitte.

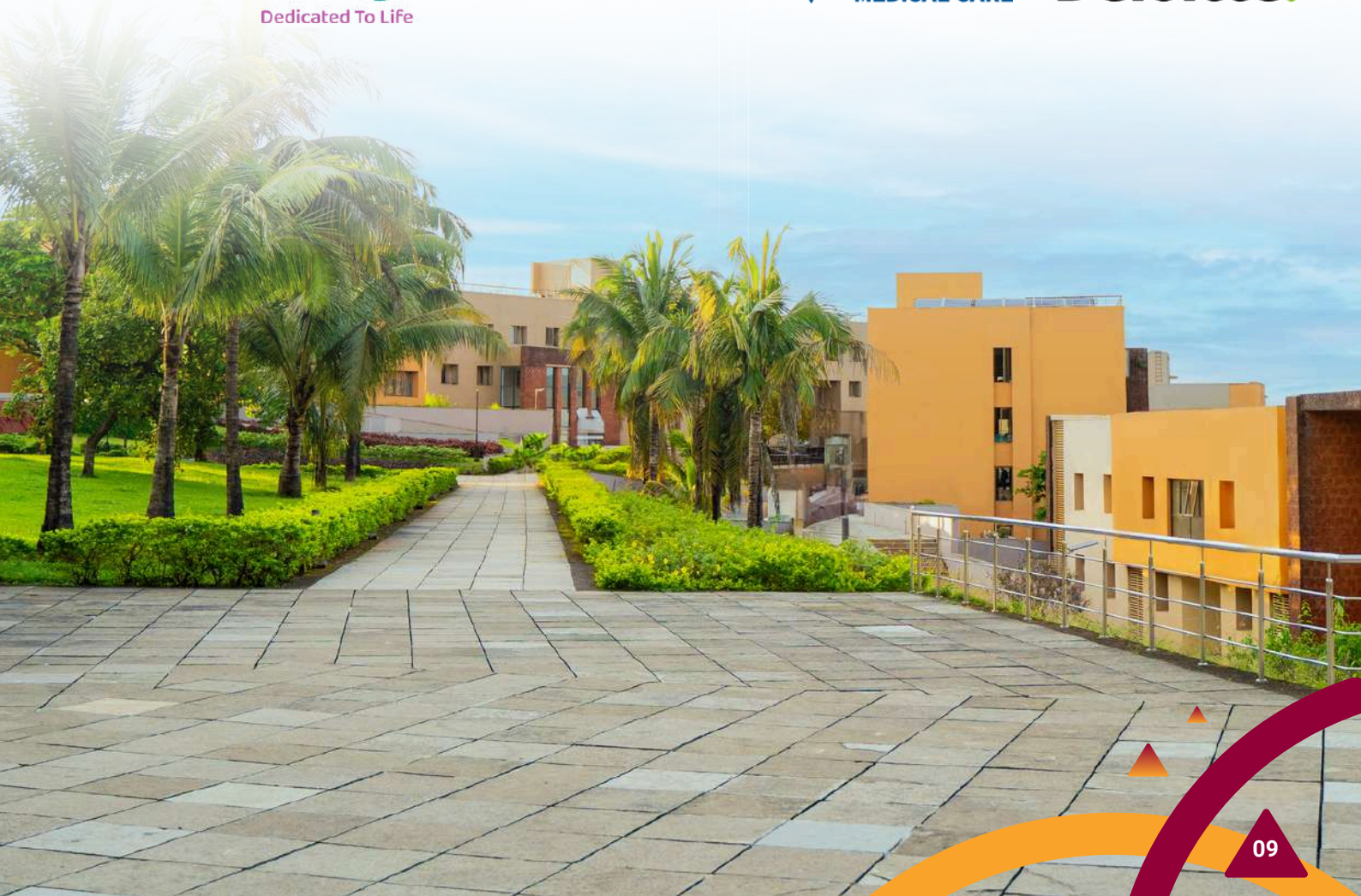

PGDM - BDA Placements

22.5 LPA
▲ Highest CTC

15.6 LPA
▲ Average CTC

14.7 LPA
▲ Median CTC

21.7 LPA
▲ Top 10% Students

21.2 LPA
▲ Top 20% Students

18.3 LPA
▲ Top 50% Students



▲ Top Recruiters



PGDM - BIFS Placements

22.3 LPA
▲ Highest CTC

15.4 LPA
▲ Average CTC

15.5 LPA
▲ Median CTC

19.85 LPA
▲ Top 10% Students

18.42 LPA
▲ Top 20% Students

16.88 LPA
▲ Top 50% Students

▲ Top Recruiters



JPMORGAN
CHASE & CO.



BNY MELLON

BARCLAYS

NOMURA



AXIS BANK

MOODY'S

Payments
Bank



TATA CAPITAL
Count on us



ICICI Bank

CRISIL
An S&P Global Company

DARASHAW

CareEdge
Ratings • Advisory • Research • Risk Solutions

IDFC FIRST
Bank

CRIF
Together to the next level

digit

niva
Health Insurance

International Double Degree in Analytics

PGDM - BDA at GIM + Masters in Business Analytics at Nova SBE, Portugal



Nova SBE

NOVA SCHOOL OF BUSINESS & ECONOMICS

#8 International Masters in Management Worldwide



The program offers a comprehensive learning experience, covering statistical theory, big data management, and business intelligence systems, including machine learning. Students gain hands-on experience with industry-standard tools and real projects. This curriculum also emphasizes designing data-driven organizations, project leadership, and leveraging data for decisions. Graduate-level training focuses on mastering data tools for effective manipulation. The program addresses the critical aspects of data-driven decisions, including limitations, human cognition, ethics, and legal constraints.

Nova SBE is a Top ranked Business School, that provides international business perspectives, with a real-world connection, both inside and outside the classroom. Nova SBE Master's programs offer unique technical and applied knowledge combined with state-of-the-art teaching methodologies.

Eligibility

- ▲ Statement of Purpose is to be submitted.
- ▲ Candidate must appear for at least one of the following English Proficiency Exams.
- ▲ with scores to be submitted by 31st January 2025 and must attain the scores mentioned:
 - ▲ TOEFL iBT - Minimum score: 100
 - ▲ IELTS - Minimum score: 7.0
 - ▲ Cambridge English Proficiency exam (CPE) - Minimum grade: C
 - ▲ Cambridge English Advanced exam (CAE) - Minimum grade: B
 - ▲ Cambridge English Business Certificates (BEC) - Minimum grade: B
- ▲ The candidates will have to appear for the GIM Analytics Aptitude Test (GAAT-To be held on 2nd February 2025) for PGDM (BDA) and the IDA programmes.

Distinguished Alumni



Mr. Raja Subramani
Class of 2000

GIM was both fun and serious work. The time management aspect was one of the best things imbibed at GIM. GIM gave a lot of confidence to face the industry as the curriculum encouraged industry interaction for every subject. Of late using the learning to raise voice against civic issues in Pune.



Mr. Alok moy Dutta
Class of 2001

Goa, a name synonymous with bright sun and alluring beaches, is akin to fun and frolic. A “Management Institute in Goa” – can’t possibly impart serious management education. This notion of thought or comments from my colleagues and acquaintances in my initial days is quite far from truth. GIM provided me a solid foundation under the aegis of great faculty and engaging pedagogy which laid emphasis on practical application alongside strong theoretical fundamentals.

GIM infused leadership, teamwork, persuasion, and going beyond one’s duties – traits that helped me thrive in healthcare corporate world for more than 2 decades. My current role at Otto Bock HealthCare India Pvt Ltd helps in creating a positive impact for Divyangs (Person with Disabilities). We as Team Ottobock try to understand their needs and provide practical solutions to celebrate Human Empowerment by making them mobile and improving their quality of lives.



Ms. Pallavi Singh
Class of 2001

Being a GIM-ite has been quite an amazing and defining experience for me personally. 2 years of GIM journey, which actually passed in a flash, kept me always on my toes due to the rigorous program and demanding professors. I also enjoyed the fun of exploring Goa with friends, endless bike rides, beach trips and hostel parties. After graduating from GIM, I started my career with TNS Global, then joined one of the largest Marketing Research and Analytics firms Nielsen. Post Nielsen, I switched to the IT Industry joining Tata Consultancy Services where Data and Analytics consulting has been my most satisfying professional experience till date. Reading, research and analysis is an aspect that has remained with me from my GIM days.

Distinguished Alumni



Ms. Simran Oberoi

Class of 2003

Being at GIM was my first experience of living in an unknown place amongst complete strangers. It set the foundation of my own personal and professional journey. I discovered my own strengths and also what I could do to create wider impact, within the corporate and societal context, both. GIM also helped me introspect about how we need to balance our aspirations against challenges that we come up against due to external factors. Most importantly, it empowered me to truly know what was in my sphere of influence and what was not. That has been a guiding principle in the social impact that I have done over the years.



Mr. Vinay Pushpakaran

Class of 2004

Perspective - if I had to sum up the biggest impact that GIM had on me in a single word, it would be perspective. The ability to view situations, challenges, opportunities and setbacks from different lenses. Be it the conversations with faculty outside the classrooms or the brainstorming sessions in the cubicles or even the adda chats at Jaggu's, it was not just about the knowledge or the fun, it was about perspective. Today, as the President of the Professional Speakers Association of India, or as the founder of a 12 year old speaking academy, or while teaching customer centricity in a B-school, it is this perspective that helps me connect with people and be a leader with clarity and resilience.



Distinguished Alumni

▲ **Ravi Rebello**

Sr. Director HR, India and HR M&A PMO,
CommScope

▲ **Nikhil Pandey**

Director, PwC

▲ **Lilton Remedios**

Associate Director,
PwC India

▲ **Sameer Mehta**

Managing Director, Head of Goals-Based
Planning | International Private Bank |
J.P. Morgan

▲ **Mahendra Barve**

Vice President of Product Development,
ITC Limited

▲ **Ranjan Arora**

Director,
BCG's Center for Customer Insight

▲ **Rohit Singh**

CEO & MD,
Daakiyaa Marketing & Logistics

▲ **Samarjeet Singh**

CEO/ Founder/ Chairman & Executive
Director, ShisenFox

▲ **Prasad Shejale**

Founder & CEO, Logicserve Digital

▲ **Thomas Reddy Aduri**

Owner, Fibonacci Advertising Pvt Ltd

▲ **Chandan Banerjee**

Senior Director, Publicis Sapient

▲ **Chetan Prasad**

Director, Capgemini

▲ **Amber Mathur**

Senior Director | Strategy & Transformation
| Supply Chain | Principal, Capgemini Invent

▲ **Richa Yadav Dash**

Principal, HR Business Partner,
Amazon US

▲ **Vimal Kumar**

Executive Director, Global Head of
Reconciliation Utility (Firm-wide),
JP Morgan Chase & Co.

▲ **Nitin Varshney**

Senior Director, Product Management,
United Health Group

▲ **Saurabh Saraswat**

Founder and Managing Director, Across
Verticals, SDN BHD

▲ **Anil Jain**

Founder & Executive Director,
AccelSoft Infotech Pvt. Ltd.

▲ **Anup R. Gore**

Founder, Gorebo

▲ **Amit Naik**

CEO, LAXMIKANT & CO

Students Speak



PGDM Core - Finance



Anuvrat Verma

PGDM CORE 2024-26

The course at Goa Institute of Management (GIM) has been a great experience, providing a solid foundation for a well-rounded understanding of business. Curriculum is thoughtfully designed, covering critical aspects from strategy to finance, ensuring no base is left uncovered. Professors play a key role in making this journey impactful, they challenge us with group assignments that foster collaboration and problem-solving, while also organizing guest lectures by industry experts that provide real-world insights. What sets GIM apart is its emphasis on case study and practical learning, ensuring that theoretical concepts are applied to real business situations. Active student clubs add another dimension to our growth, conducting competitions and alumni sessions that offer networking opportunities and leadership development. GIM also allows us to build and manage our priority pyramid, balancing academics, personal growth, and extracurricular activities. It's an environment where we not only learn but also evolve into future business leaders.

PGDM Core - Human Resource



Janice Ganatra

PGDM CORE 2024-26

Pursuing my PGDM at Goa Institute of Management (GIM) has been an incredible journey of learning and growth. Course offers in-depth exploration of various aspects of human resources, from talent management to organizational behavior, giving me a comprehensive understanding of the field. What truly stands out is the emphasis on peer-to-peer learning, discussions and interactions with my diverse batchmates as well as encouragement from faculty members have enriched my learning experience and helped me gain different perspectives on real-world challenges. Being a part of the HRiday club has further enhanced my understanding of HR, with opportunities to collaborate on projects and events. Adjusting to new subjects has posed its challenges, but dynamic environment at GIM, paired with support of faculty and peers, has made it a fulfilling learning experience. Campus itself, with its serene surroundings and state-of-the-art facilities, provides the perfect backdrop for both academic and personal growth. With its focus on practical learning and highly relevant content, the program has thoroughly equipped me for a future in HR, making my experience at GIM both fulfilling and enriching.

PGDM Core - Operations



Badrinath Nayak K

PGDM CORE 2024-26

My journey at Goa Institute of Management (GIM) has been truly thrilling so far. The holistic learning experience has exceeded my expectations, with a course structure that aligns perfectly with industry requirements. Insights from faculty have broadened my understanding of operations management. I'm also pleased that my work experience has significantly enriched the cohort's learning. Supportive atmosphere here has facilitated effective group work, enhancing my team discipline. Valuable inputs from industry veterans has been instrumental in shaping my understanding of the field and my career perspective. Campus not only meets my academic needs but also promotes overall development, from time management to pursuing my interests in sports and culture. Unique programs at GIM have encouraged me to think beyond corporate life and engage in sustainable practices, emphasizing the importance of giving back to society in today's fast-paced world. I believe that my experience here, which began as a student, will ultimately transform me into a successful manager by the end of this program, helping me achieve the goals I envisioned before joining.

PGDM Core - Strategy & Consulting



Diveta Mishra

PGDM CORE 2024-26

Pursuing my PGDM at Goa Institute of Management (GIM) with a minor in Strategy and Consulting has significantly sharpened my skills in communication and problem-solving. Rigorous academic curriculum, combined with real-world case studies, consistently pushes me to think critically and act promptly in high-pressure situations. Faculty plays a crucial role in creating an environment that challenges us but also fosters mutual learning. One of the most rewarding aspects of this program is the emphasis on interactive learning. Group assignments and projects allow us to pool together our diverse perspectives and experiences, given that my peers come from various professional and cultural backgrounds. This diversity enhances the learning experience, offering fresh insights and innovative solutions to complex problems. These collaborations help in developing teamwork and leadership skills and prepare us for dynamic and multifaceted challenges in consulting and strategic roles we aim to pursue. Constant exchange of ideas and constructive feedback has been instrumental in shaping my overall growth and readiness for the future.

PGDM Core - Marketing



Shreyas Kulkarni

PGDM CORE 2024-26

My journey at Goa Institute of Management (GIM) has been truly enriching. From day one, I felt part of a vibrant community that encourages collaboration, creativity, and fresh thinking. The course offers a great mix of theory and hands-on learning, making complex ideas easier to grasp and apply. What really stands out for me is the range of experiences, dynamic classroom discussions, presentations, and practical insights that go beyond textbooks. While I've chosen marketing as my major, learning environment at GIM has expanded my thinking beyond one field, shaping a well-rounded perspective. It's not just about academics here; GIM has pushed me to think critically and act with integrity. Overall experience so far has been exciting and has laid a strong foundation for what's to come. I look forward to leveraging these experiences as I embark on my professional journey.

Students Speak

Healthcare Management



Sweta Singh

PGDM-HCM 2024-26

My experience at Goa Institute of Management (GIM) has been incredibly rewarding, particularly through the healthcare management programme. GIM offers a vibrant, collaborative environment where academic learning is blended with practical exposure, helping me grow both personally and professionally. The emphasis on real-world learning through case studies and industry interactions has enabled me to apply classroom knowledge to real healthcare challenges. Engaging in discussions and hands-on projects is shaping my development as a future healthcare leader. Faculty at GIM bring a wealth of industry knowledge and academic expertise, making learning both practical and insightful. Supportive environment at GIM, along with the programme's focus on academic rigour and practical application, is preparing me to excel in the dynamic and challenging world of healthcare management, turning this into a truly transformative journey.



Haaris Ali

PGDM-HCM 2024-26

It has been an extremely enriching experience so far in the PGDM-Healthcare Management programme at Goa Institute of Management (GIM). The curriculum is holistic, offering an excellent combination of theoretical knowledge and hands-on learning opportunities, all of which are essential for standing out in current competitive healthcare sector. GIM's faculty, with their extensive industry experience, provide valuable insights and mentorship, making classes highly engaging. I also find that the collaborative environment at GIM fosters creativity and critical thinking, continually inspiring me to take on real-world projects. Valuable industry connections through GIM are also providing a strong foundation for networking with leaders in healthcare field. Overall, the holistic learning and development at GIM have exceeded my expectations, and I am confident that my journey here will equip me to make a meaningful contribution to healthcare industry.

Students Speak

Big Data Analytics



Moksh Grover

PDGM BDA 2024-26

Pursuing Big Data Analytics at Goa Institute of Management (GIM) has been a truly rewarding experience. The program offers a balanced mix of managerial and technical skills, making it highly relevant to ever evolving data-driven landscape. Faculty does a remarkable job of simplifying complex concepts, ensuring that we not only understand theory but also apply it practically. One of the standout features at GIM is state-of-the-art data labs, available to students round the clock. These labs allow us to explore practical side of analytics at our own pace. Learning experience extends beyond classroom, with regular sessions from industry leaders that provide valuable insights into real-world challenges. We also get hands-on opportunities to work on live projects with top companies, which adds immense value to our learning. Vibrant campus life at GIM is another highlight. Frequent extracurricular activities and events offer a welcome break from academics, making it easier to manage the rigorous coursework. Diverse student body brings together perspectives from all over the country, fostering a collaborative and dynamic learning environment. With GIM's excellent facilities and support systems, I feel fully equipped for the challenges of analytics industry. This journey is helping me grow both personally and professionally, and I'm confident it's shaping me into a well-rounded professional ready to thrive in the world of big data.



Eshika Jain

PDGM BDA 2024-26

Goa Institute of Management (GIM) is a place that truly feels alive. The campus is surrounded by beautiful greenery, giving it a peaceful, eco-friendly vibe. GIM puts a lot of emphasis on sustainable practices, which I really appreciate. Hostels are fully furnished and make life on campus comfortable and convenient. But what stands out the most to me is how there's always more to do than just study. GIM has so many clubs and activities that let you explore your interests outside of academics. On-campus festivals and events bring everyone together, making it easy to meet new people and build friendships in a fun, relaxed setting. As for the Big Data Analytics (BDA) programme, it's been a great experience so far. The curriculum is well-rounded, covering machine learning, AI, data visualization, and predictive analytics. What I like most is hands-on training we get in tools like Python, Tableau, and Power BI. It's not just theory, but real-world skills that we can apply directly. Coming from a non-engineering background, I was a bit nervous about how I'd manage. But the way the program is designed makes it easy to follow along, and I've been able to build on my own knowledge while learning data analytics step by step. This program has really helped me gain confidence in this field, and I feel much more prepared for the future.

Students Speak

Banking, Insurance and Financial Services



Maurya Bhatt

PGDM-BIFS 2024-26

As a student in the PGDM BIFS programme at Goa Institute of Management, my experience has been nothing short of remarkable. The programme offers a well-rounded approach to finance, blending cutting-edge theories with practical insights that truly prepare us for the industry. Professors are approachable and bring a wealth of real-world experience to the classroom, making learning engaging and relevant. What I appreciate most about the campus is its vibrant atmosphere. Beyond academics, there are countless opportunities to get involved in clubs, sports, and cultural activities, all of which foster a strong sense of community. These experiences have helped me develop essential skills like teamwork and leadership in a supportive environment. Overall, my time at Goa Institute of Management has been transformative. It has not only deepened my knowledge of finance but also helped me grow personally and professionally. I wholeheartedly recommend this program to anyone looking to thrive in their career while enjoying a lively and inclusive campus life.



Aayush Jain

PGDM-BIFS 2024-26

As a student at Goa Institute of Management enrolled in PGDM - BIFS programme, I have experienced a dynamic and enriching campus life that fosters both academic excellence and personal growth. Curriculum of BIFS course is meticulously designed to reflect current trends in finance sector, providing us with essential skills and knowledge required to excel in our careers. Faculty members are not only highly knowledgeable but also deeply committed to our learning, striking an effective balance between theoretical concepts and practical applications. This holistic approach ensures that we are well-prepared to navigate the complexities of finance industry. Additionally, vibrant campus life promotes a sense of community and encourages involvement in various extracurricular activities, including sports, which enhance teamwork and leadership skills. Overall, my experience at Goa Institute of Management has been transformative, equipping me with both the competencies and confidence needed to succeed in a competitive environment. I wholeheartedly recommend this program to anyone aspiring to build a robust career in finance.

Admission Procedure



Applications for Admission to full time PGDM programs are invited from graduates. Shortlisted candidates are invited for a further evaluation.

1

2

▶ Minimum 50% aggregate in Bachelor's Degree

Candidates in the last year of degree should have obtained a minimum 50% aggregate (45% for SC/ST category) in the latest examination.

3

4

▶ Candidate must have taken/ appeared for any one of the following: XAT 2025, CAT 2024, GMAT taken between 01 January 2023 to 15 January 2025.

*Admission Procedure Students Intake Batch of 2025-27 **

Click here to refer official website for details *

For IDA Candidate must appear for at least one of the following English Proficiency Exams amongst TOEFL iBT, IELTS, Cambridge English Proficiency exam (CPE), Cambridge English Advanced exam (CAE), Cambridge English Business Certificates (BEC). The candidates will have to appear for the GIM Analytics Aptitude Test (GAAT).

Students Intake

Batch of 2025-27

Programme

Intake Capacity

PGDM

300

PGDM (HCM)

60

PGDM (BDA)

180

PGDM (BIFS)

120

IDA

(PGDM BDA +
MSc. in Analytics)

30



Achievers Round

Achiever's Round: The Achiever's Round is a profile-based shortlisting process that evaluates candidates based on program-specific or other achievements in areas such as academics, sports, co-curricular activities, and professional experience. This round applies to all programs based on the candidate's first preference. Candidates are shortlisted for the Achiever's Round without considering CAT/XAT/GMAT scores initially, which will be factored in later. Select candidates may receive a spot admission offer, while others will be considered alongside regular applicants. The centre locations will be in Goa and Delhi.

Program-Specific Achievements: Academic toppers from select institutes, MBBS, CA/CS/ICWA/CFA (US) holders, and engineering graduates with at least 24 months of full-time work experience in specific companies are invited to the Achiever's Round based on their first program preference.

Regular Round

The interviews will be conducted online. For the PGDM program, candidates are shortlisted based on the cutoff scores of competitive exams. For HCM, BDA, BIFS and IDA programs, shortlisting is based on the candidate's overall profile, which includes their academic record, work experience, and competitive exam performance. There is no stipulated cut off for the competitive exams.

	Deadline	One Programme	Two Programmes	Three Programmes	Four Programmes
First Mover	24th Oct 2024	1750	2000	2250	2750
Early Bird	28th Nov 2024	2000	2250	2500	3000
Achiever's Round Deadline	05th Dec 2024	2500	3000	3500	4000
CAT Deadline	23rd Dec 2024	2500	3000	3500	4000
Last Date	02nd Jan 2025	2500	3000	3500	4000

***18% GST Applicable**

Application link : <https://admissions.gim.ac.in/>

Scholarships & Loans

GIM maintains diversity, access and quality by providing scholarships for meritorious students. Following scholarships are given to deserving candidates who fulfill all the terms and conditions:

PGDM (Full Time)

- ▲ Academic Competence and Excellence Scholarship Scheme (ACCESS)
- ▲ Scholarships for 45 students, each worth ₹5,00,000

PGDM - HCM

- ▲ GIM - MBBS Scholarship (GMS)
- ▲ 07 Scholarships Each Worth ₹5,00,000

PGDM - BDA (Full Time)

- ▲ Academic Competence and Excellence Scholarship Scheme (ACCESS)
- ▲ Scholarships for 21 students, each worth ₹5,00,000

PGDM - BIFS

- ▲ Academic Competence and Excellence Scholarship Scheme (ACCESS)
- ▲ Scholarships for 07 students, each worth ₹5,00,000

Scholarships valued at ₹2.5 Lakhs are available for the IDA Program

Studying at GIM involves a minimal amount of cash out flows for most students. Various banks provide pocket friendly loans to GIM students.



Bank of India

Loan of upto ₹25,00,000



State Bank of India



HDFC Credila

Loan of up to 100% cost of education



Bank of Baroda

Loan of upto ₹30,00,000



IDFC First Bank

[Know more](#)

Government educational loan facility for Goan domicile students. The Government of Goa offers educational loans up to Rs. 8 Lakhs for eligible Goan domicile candidates. For availing this facility and more information, please visit www.dhe.goa.gov.in.



Full Tuition Fee Waivers

Eligibility

- ▲ Students whose family income is less than Rs. 8 lakhs/annum are eligible.

Terms and conditions

- ▲ The Tuition Fee Waivers may be awarded to deserving students subject to a maximum of 5% of the students admitted.
- ▲ The award shall be based on assessment of the financial need, considering total family income and economic condition of the family.
- ▲ The awardees would get a full waiver of the Tuition fees.
- ▲ For batch 2025-27, the Tuition fee component is ₹13,12,000.

Program Academic Fee

Once you receive the acceptance letter for admissions, the process for fees submission starts from March 2025. You can pay your fees by debit card, credit card, demand draft and more.

Academic Fee Installment Schedule for Batch 2025-27

01 Inst 1a (Mar-Jun 25) ₹ 50,000

02 Inst 1b (Mar-Jun 25) ₹ 4,60,000

03 Inst 2 (Oct 25) ₹ 5,10,000

04 Inst 3 (Jun 26) ₹ 10,20,000

For IDA Payable at GIM: ₹ 14,97,000
at Nova SBE: € 10,000

**The academic fees for the batch 2025-27 is subject to change.*



International Admissions



GIM welcomes students from anywhere in the world who aspire for cutting-edge business education while located within the natural surroundings of picturesque Goa. With campus placements and summer internships, all the programmes are suitable and contemporary for students of any nationality. In addition, Goa is a very diverse and inclusive society with a rich history that has shaped a very accommodating culture of the present. It is one of India's most popular tourist destinations and boasts of scenic beauty and exotic cuisine. It is also home to numerous industries and India's best healthcare services.

Eligibility

- ▲ The student must be a foreign national or NRI. A foreign national is defined as someone who has a passport issued by a country other than India.
- ▲ NRI means Non-resident Indian as defined in Income Tax Act, 1961.
- ▲ All applicants must have scored at least 50% aggregate in their Bachelor's degree, awarded by a recognized university.
- ▲ Valid GMAT score of GMAT taken in 2023/2024/January 2025.
- ▲ TOEFL score for applicants whose medium of instruction has been a language other than English.

Fee Structure 2025-27 Programme Fees:

- ▲ PGDM, PGDM-HCM, PGDM-BDA, PGDM-BIFS: US \$14,000 per year
- ▲ The academic fees are subject to change for the Batch of 2025-27

International Exchange Partners

- 01 **CLSBE** (Catolica Lisboa School of Business and Economics), Lisbon
- 02 **ISCTE**, Lisbon, Portugal
- 03 **Lappeenranta University of Technology**, Lappeenranta, Finland
- 04 **Universiteit Antwerpen**, Antwerp, Belgium
- 05 **Kansas University School of Business**, Kansas, USA
- 06 **Warsaw University Technology Business School (WUTBS)**, Warsaw, Poland
- 07 **The Institute of Higher Education in Management (HEM)**, Morocco
- 08 **Sapir College**, Israel CUNEF, Madrid, Spain
- 09 **North-South University**, Dhaka, Bangladesh
- 10 **JIMMA University**, Ethiopia
- 11 **Kathmandu University School of Management**, Nepal
- 12 **American International University**, Bangladesh
- 13 **Fundação Gelutio Vargas**, Sao Paolo, Brazil
- 14 **Alba Graduate Business School**, Greece
- 15 **Mondragon University**, Spain

▲ GIM & WUTBS Study Tour

GIM sends 20-25 students annually to WUTBS in Poland for 8- 10 days. Tour focuses on Polish culture and emerging business sectors, with discussions, lectures, and field visits.

▲ GIM & Alba Graduate Business School, Greece Study Tour

GIM sends 20-25 students annually to Alba Graduate Business School in Greece for 8-10 days. The students work on live projects with companies in Greece.

▲ GIM & University of Antwerp Tie-up

International Consulting Bootcamp held annually in September between GIM & UoA Students from both institutes work on live projects in Goa, India Boot camp provides cross-cultural experience and learning opportunity.

▲ Country Immersion Program

Allows students to understand host country's business dynamics through trade, politics, and society. Includes industrial visits and interaction with business leaders, and cultural visits. Partner institutions: Kansas University (USA), WUTBS (Poland).



Infrastructure & Facilities



— 50 Acres of Eco-Friendly Campus

GIM's picturesque campus is a slice of paradise, nestled in the beautiful Sahyadri's foothills. A 745kW solar energy plant powers this eco-friendly campus. Various other green initiatives such as Rain Water Harvesting, Sewage Treatment Plant are undertaken by the Institute for its commitment to sustainability and environmental friendliness.



— Atal Incubation Centre

The Atal Incubation Centre at GIM (AIC-GIM) helps turn ideas into successful startups. The center provides seed funding, co-working spaces, workshops, and networking events to help students develop their skills and connect with industry leaders. AIC-GIM is a sector-agnostic incubator supported by the Indian government and has helped incubate 32 startups from 2018 to 2020. It provides entrepreneurs access to finance, market, & talent through physical, virtual, and on-demand incubation services.



— Hostel Facilities

Our separate on-campus hostels for Boys and Girls offer conveniently shared living spaces and clean and secure facilities. HDFC Bank Limited has installed an ATM inside the campus, which provides round-the-clock 24x7 banking services.



— Sports Facilities & Fitness Centre

Our on-campus suite of athletic and fitness facilities will help you stay healthy, fit, and mentally grounded. It includes Swimming Pool, Badminton court, Basketball court, Football Field, Tables tennis and Volleyball court. The indoor fitness center inside the Multipurpose Hall features cardio and weight. It has treadmill, kickboxing, and the latest fitness equipment.

Infrastructure & Facilities



Medical Facilities

The campus has an on-campus health center with a paramedical care team. It has also tied up for services of a leading doctor visiting the students regularly on campus. In emergencies, patients are taken to the well-equipped district hospital, which is just 2 km away from the campus. Institute has an MoU with HealthWay Hospitals for priority admission facilities.



Food Court

A vast food court with a comfortable seating capacity is located in the heart of the campus. It offers a variety of cuisines depending on the taste of the students. From thalis to burgers and from sandwiches to fries, it is the perfect place to grab a bite on your way to classes.



Hangout Zone

Recently opened and often crowded, the hangout area of the new canteen offers an array of seating where students can catch up between lectures amidst the blue Goan skyline. It is a perfect place to chill together with friends.



ABE Auditorium

The newly opened auditorium, with a capacity of over 300, has quickly become a premier venue for hosting prestigious international and national events, alongside a variety of dynamic student-led initiatives.

Student Clubs

- ▲ **Aarohan:** The Leadership Interaction Club of GIM aims to incorporate leadership qualities through various talks, workshops and events. We host Samriddhi: The Annual Business Flagship Symposium of GIM, Wine Tasting Etiquette and Ribandar Talk Series.
- ▲ **AgoraLokniti:** Agora x LokNiti is the premier club for public speaking and public policy where we teach students how to improve their public speaking abilities and increase their understanding of what's going on at the federal level and how it affects our daily lives.
- ▲ **The Health Club:** A campus sustaining club, liaising between different vendors on campus, students and the on campus by looking after food, gym and swimming pool.
- ▲ **Industry Institute Interaction Club:** i3 club acts as bridge to provide corporate projects to each student of GIM, make available opportunities for students to put their classroom learning to practice and cover application of all management disciplines.
- ▲ **Inception:** Inception, the Performing Arts Society of Goa Institute of Management, organizes events promoting creativity and art forms for students throughout the year.
- ▲ **Razzmatazz:** Creating a vibrant campus experience by organizing different cultural events and parties, adding a zing of rejuvenation in the hectic curricular life.
- ▲ **Cognition:** The vision of the society is to create evangelists who would propagate knowledge and insights of data science among the student community as well as

outside of it. The society envisions positioning GIM as the vanguard institute for data science in the country and possibly beyond it. It conducts events across the year involving students and industry leaders to bridge the knowledge gap and empower the realm of Data Science & Analytics.

- ▲ **TEDxGIM:** The Goa Institute of Management, a prestigious business school in India, hosts the TEDxGIM event. The goal of TEDxGIM is to use TED's approach and not just provide attendees with a day fluffed with mind-boggling knowledge but also a thought-provoking spark for the GIM, Goa, community.
- ▲ **SOFIA:** The Finance Club of GIM organizes events and activities to help students develop finance acumen and impart knowledge on the latest happenings in the finance world. Provide finance enthusiasts with the scope and opportunities available in the field of finance and guide them in crafting their way to making a successful career in the finance domain.
- ▲ **Brainvista:** We are a group of individuals who are passionate about trivia and love to challenge ourselves and others with interesting and thought-provoking questions. Our goal is to provide a platform for like-minded individuals to come together and test their knowledge in a fun and engaging way. Curio Curio, the ultimate creative club of GIM gives students a platform to enhance the students' creativity with innovative, creative and fun events.



- ▲ **PR Cell:** The Student Public Relations Cell at GIM is a student-run initiative that serves as the main point of contact for prospective students seeking information about the quality of education at the institution while accurately representing the brand. The cell manages external interactions and publicises events and convocations.
- ▲ **MECCA:** The marketing club of Goa Institute of Management is the core club responsible for handling and providing a platform for students to apply their marketing acumen. Around the year, the club hosts various fun, creative and skill testing events such as Bootcamp, Sale Away, GIM Wizbiz, Chrysalis.
- ▲ **INVICTA:** The Operations and Consulting Club of GIM, aims at inculcating the students with the knowledge of Operations & Consulting by bringing the domain to real-life situations, to our daily lives by exploring new challenges each time in order to make learning more interesting. Our endeavour is to equip students with the right tools to build key competencies and skills that can be leveraged to build their prospective careers.
- ▲ **HRiday:** The HR Club of Goa Institute of Management, focuses on the holistic development of students. It and cooperation. People, Passion, and Performance-our motto, drives the student club to organize a series of events in the field of HR domain, like national-level HR case study competitions, talks with industry leaders, and simulations throughout a calendar year.
- ▲ **Samarthan:** Is a student-driven CSR club of GIM that promotes the culture of being socially responsible among budding managers and stresses the importance of giving back to society. It provides a platform for students to strive and bridge the gap between ideas and actions, thus contributing to societal betterment.
- ▲ **Prayas:** "Sports gives your life structure, discipline, and a genuine, sincere, pure fulfilment that few other areas of endeavor provide." Advocating on the same principle, Team Prayas organizes more than 20 events a year, from sporting to cultural events. The team also looks after the sporting equipment and infrastructure in GIM, fuelling the spirit of sports on campus throughout the year.
- ▲ **Vinidhan:** Conceptualized in 2013 as an equity fund with the objective of providing a platform for students to learn through the experience of managing a real investment fund. While 'Learning' is the primary objective of Vinidhan, the goal is to be recognized as a professionally managed fund in the financial world.
- ▲ **S.A.R.C.:** The Student Alumni Relations Cell works towards promoting, nurturing and building strong bonds between the Institute and its decorated Alumni network. We strive to provide an opportunity for connecting students and faculty to interact with the Alumni.
- ▲ **E-Cell:** The Entrepreneurship Cell at GIM is a prominent student body that promotes and celebrates the entrepreneurial spirit amongst the students and encourages them to be budding entrepreneurs. We provide a platform for student startups on campus to connect to incubators, seed funds, and angel investors.
- ▲ **OxyGIM:** Music is the language of the spirit. The band gives every GIM student, the opportunity to display their musical talent in OxyGIM, an open music ensemble. Students can play at a variety of college events, such as open mic nights, Oxygim Night, Inception Due to its inherent universality, music unites people from all corners of the globe. OxyGim connects the students of GIM through the language of music.



Centres of Excellence

▲ Centre for Excellence in Research (CER)

The Centre for Excellence in Research (CER) aims to promote and foster research culture with objectives such as building a culture of research, fostering an environment that encourages research, promoting high-quality research among faculty members, imbuing research-driven pedagogy among students, and positioning GIM as a thought leader in the management community. The center shapes research policy, evaluates research infrastructure and assesses research quality, ensures ethical standards and arbitrates on research-related disputes.

▲ Centre for Excellence in Sustainable Development (CESD)

The Centre for Environmental Sustainability and Development (CESD) was formed in 2018 to contribute to GIM's quest for environmental sustainability through knowledge creation, action research, and dissemination, development of a resource center, participation in policy making, contribution to sustainability startups, sustainability activities, stakeholder communication, student engagement, international activities and focusing on priority SDGs 6, 7, 11, 12, 13.

▲ Centre for Social Sensitivity and Action (CSSA)

The Centre for Social Sensitivity and Action (CSSA) at Goa Institute of Management (GIM) contributes to the society and the institute through research, training, workshops, academic and community-based activities. It promotes responsible management education, prepares leaders for complex sustainability challenges faced by business and aligns its activities with the UN Sustainable Development Goals (SDGs) and the PRME initiative. Priority SDGs of CSSA are SDG3, SDG4, SDG5, SDG8, SDG10, SDG12 and SDG17.

▲ Centre for Creativity, Innovation & Design Thinking (CCIDT)

Design Thinking is a critical tool used in problem-solving in the workplace, it uses a human-centered approach to find sustainable solutions to existing problems. The Centre for Creative and Innovative Design Thinking (CCIDT) develops multiple skills of students by providing rich opportunities to find a voice for their creative expression through theatre, dance, short-film making, photography, art, and music.

▲ Centre for Public Policy and Governance (CPPG)

The Centre for Public Policy and Governance (CPPG) at GIM aims to explore the links between management and public policy, generate and lead intellectual capital and experience to inform public formulation and governance in India and emerging economies, create awareness among the student community by discussing and analyzing public policies and serve as a platform for academics, policymakers, and governance to interact and dialogue.



Post Graduate Diploma In Management Hybrid

AICTE approved 2-year Post Graduate Diploma in Management program that offers the best of both worlds – online and in-person learning. Designed for professionals and entrepreneurs who face challenges in pursuing traditional full-time education, this program enables participants to receive top-tier management education while balancing work and personal life. With the added convenience of online components, the program offers an accessible solution to those seeking to advance their management skills and knowledge.

▲ **Accredited Management Degree:**

Obtain a postgraduate management degree from a top Bschool with AICTE accreditation, while balancing work or job.

▲ **Trusted Institute:**

Join GIM, an institute with a legacy of providing world-class management education for over three decades and ranked 37th in India.

▲ **Designed for Working Professionals:**

PGDM (Hybrid) is tailored for experienced executives, entrepreneurs, and professionals seeking advanced management education.

▲ **Learn and Apply:**

Balance learning and application by studying on weekends and applying skills during the week, with flexible semester-based program and multiple exit points.

▲ **Reasonable Fees and Flexible Fee Payment Mechanism:**

This is to support you in investing in your own future, and get the best value on your investment.



Management Development Programmes (MDP)

GIM's MDPs are designed to meet the needs of executives at all levels: senior and mid-level executives, professionals from start-ups, and new hires. The programmes equip students with a wide range of vital skills required to thrive in today's fast-paced global business world. GIM provides a range of standardized and tailored programmes for working professionals, both long and short in duration.

We also provide a number of in-house programmes tailored to the client's individual requirements. The availability of teachers from numerous fields such as finance, human resources, data science, healthcare, operations, and marketing gives us the capacity to respond to and adapt to the unique needs of various firms who wish to conduct trainings at our institute. To make it a beneficial experience for the learners, the experienced faculty employ a number of pedagogical approaches such as caselets, discussions, interactive and educational movies, outdoor activities, and so on.

We have held MDPs for a variety of customers from industries such as pharmaceuticals, manufacturing, energy, real estate, information technology, educational institutes, public service, and administration over the years. Among the firms for whom we have provided training are Johnson & Johnson, MetLife, HPCL, ONGC, and Adani Group, to mention a few. As we move ahead, we will continue to provide intense and transformative learning experiences for executive learners. We cordially invite you to join us on this remarkable adventure. [Click here](#)



Fellow Programme In Management

The FPM is a doctoral program aimed at training research scholars for careers in academia and industry. The program is divided into three phases: Course Work, Comprehensive Exam, and Thesis Work and typically runs for four years. Participants receive scholarships and work as teaching and research assistants, and attend conferences and workshops to develop their knowledge, research skills, and teaching abilities. The program aims to equip scholars with advanced analytical and practical skills necessary for success in academia and industry.

Eminent Guest Speakers at GIM



Mr. Puneet Gulati
(Ex CEO, Barista- Lavazza)



14th Dalai Lama
(Spiritual Leader)

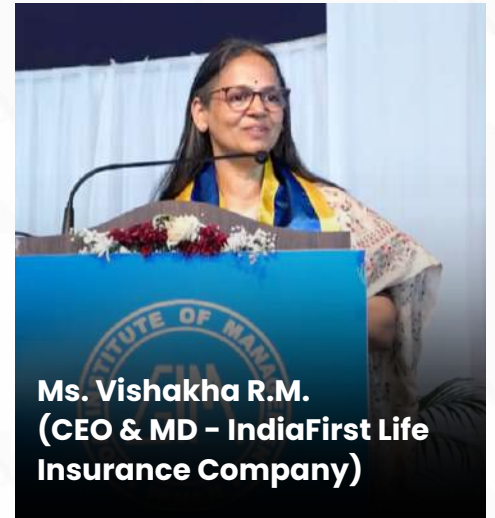

Ms. Vishakha R.M.
(CEO & MD - IndiaFirst Life Insurance Company)

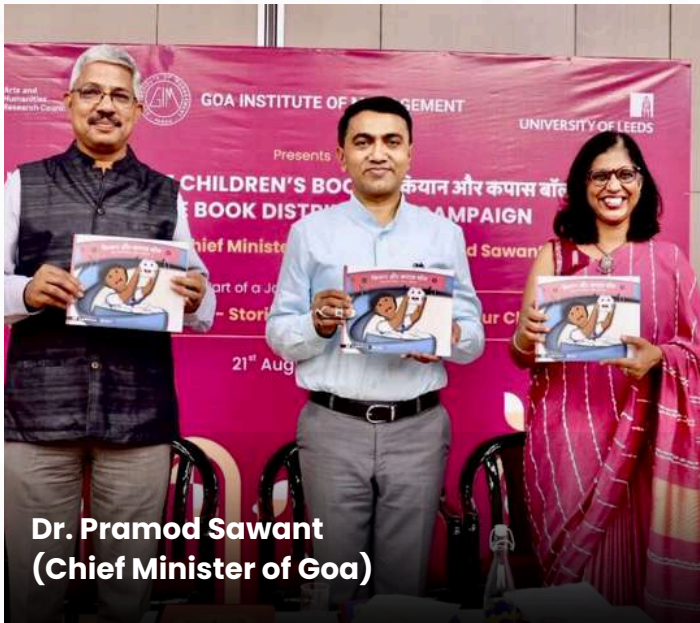

Dr. Pramod Sawant
(Chief Minister of Goa)



Mr. Ankur Warikoo
(Entrepreneur)



Mr. Snehal Desai
(Senior VP, Adani Group)

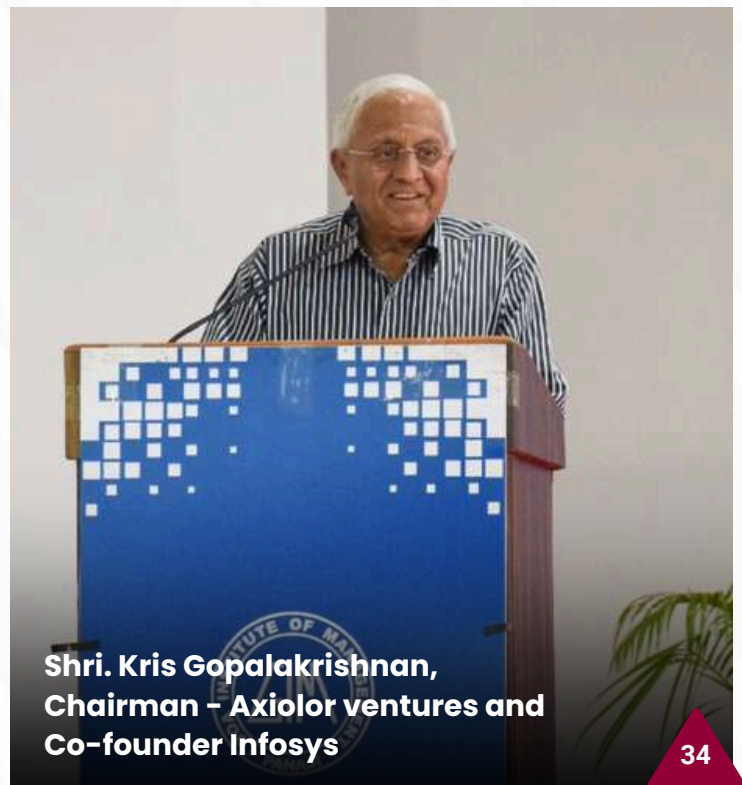

Shri. Kris Gopalakrishnan,
Chairman - Axiolor ventures and
Co-founder Infosys

Eminent Guest Speakers at GIM

▲ **Mr. Satish Pradhan**
Ex Executive Vice President,
TATA Sons

▲ **Mr. Birender Ahluwalia**
CEO,
The Positivity Co.

▲ **Mr. R Srinivasan**
PGP Chair,
IIM - Bangalore

▲ **Mr. Sharad Vivek Sagar**
Founder & CEO, Dexterity Global Group

▲ **Mr. Dan LeClair**
CEO, Global Business School Network

▲ **Mr. Rajesh Srivastava**
Corporate Trainer

▲ **Puneet Mahajan**
Executive VP and CFO - Suffolk

▲ **Rajesh Gupta**
CEO - Mahindra South Africa

▲ **Mr. Siddhant Shah**
Founder, Access for all

▲ **Mr. Satish C Mehta**
Former Indian Foreign Service Officer

▲ **Ms. Sophia David**
Learning Consultant, Deloitte

▲ **Mr. Anand Bhatnagar**
Assistant Vice President, Reliance

▲ **Mr. Ashutosh Chadha**
Director & Country Head,
Microsoft

▲ **Dr. Nisha Khanna**
Mental Health Practitioner,
Bye Tense Mental Health

▲ **Ms. Ruchika Mehta**
Director- Communications & PR,
The Park Hotels

▲ **Ms. Shalini Goyal Bhalla**
Managing Director, ICCE

▲ **Shifali Jain**
Founder, Diveristy Dialogues

▲ **Mr. Prakash Gurmoorthy**
Partner & MD - Asia Pacific, Born Group

▲ **Mr. Rajan Sethuraman**
CEO, Latent View Analytics

▲ **Mr. Ashwin Bajaj**
CEO, Leveraged Growth

▲ **Shantanu Naidu**
Founder of Goodfellowsindia and Motopaws &
General Manager at the office of Ratan Tata

▲ **Dr. Naresh Tyagi**
Chief Sustainability Officer,
Aditya Birla Fashion

▲ **Mr. Priya Ranjan Kumar**
Vice President & Head HR- J&W Steel Ltd

▲ **Mr. Chhitiz Kumar**
Vice-President, Healthcare, Philips

Goa Institute of Management

Faculty Members



Ajit Parulekar

Director
Health Care Management



D N Venkatesh

Dean, Professor
OB & HR



Sumit Datta

Registrar, Admin



Akshay Bhat

Assistant Professor
Strategy & Consulting



Aman Bhuwania

Assistant Professor
Strategy & Consulting



Andy Silveira

Assistant Professor
Strategy and Consulting



Dibyendu Sharma

Senior Lecturer
Strategy and Consulting



Karman Khanna

Assistant Professor
Strategy & Consulting



Rohit Prabhudesai

Associate Professor
Strategy & Consulting



R Rathish Bhatt

Associate Professor
Strategy & Consulting



Shiv Nath Sinha

Associate Professor
Strategy & Consulting



Sneha Bhat

Assistant Professor
Strategy and Consulting



Allan Bird

Adjunct Faculty
OB & HR



Anamika Sinha

Professor
OB & HR



Anshul Mandliya

Assistant Professor
OB & HR



Israel Fortin

Assistant Professor
OB & HR



**Muneeb Ul Lateef
Bandy**

Assistant Professor
OB & HR



Saswata Barpanda

Associate Professor
OB & HR



Shelly Pandey

Assistant Professor
OB & HR



V. Padhmanabhan

Associate Professor
OB & HR



Deepti Mohan

Assistant Professor
IT & Operation
Management



Kiran K

Associate Professor
IT & Operation
Management



**Lakshmi Vishnu
Murthy Tunuguntla**

Professor
IT & Operation Management



Raj V. Amonkar

Professor
IT & Operation
Management



Rakesh Shrivastava

Professor
IT & Operation
Management



Rohit Mutkekar

Associate Professor
IT & Operation
Management



Shubhendu Singh

Assistant Professor
IT & Operation
Management



Stuti Arora

Assistant Professor
IT & Operation
Management



Vishwesh Singbal

Assistant Professor
IT & Operation
Management



**Vithal
Sukhathankar**

Associate Professor
IT & Operation
Management



Aanchal Singh

Assistant Professor
BIFS



Abhinav Sharma

Assistant Professor
BIFS



Abhishek Ranga

Professor
BIFS



Deepali Kalia

Assistant Professor
BIFS



**Anubhav Anand
Mishra**

Professor
Marketing



Diya Guha Roy

Associate Professor
Marketing



Kanupriya Katyal

Professor
Marketing



Manu C.

Assistant Professor
Marketing



Mauli Soni

Assistant Professor
Marketing



Nandakumar Mekoth

Professor
Marketing



Pravat Surya Kar

Associate Professor
Marketing



Ranbir Singh Sodhi

Assistant Professor
Marketing



Shantanu Prasad

Associate Professor
Marketing



Vikram Choudhary

Assistant Professor
Marketing



Yukti Sharma

Associate Professor
Marketing



Amiya Kumar Sahu
Associate Professor
Finance



Arpita Amarnani
Associate Professor
Finance



Ashay Kadam
Professor
Finance



Hanish Rajpal
Associate Professor
Finance



Kaushik Desarkar
Assistant Professor
Finance



Manas Mayur
Associate Professor
Finance



Neeraj Amarnani
Professor
Finance



**Neetant Sinai
Shirodkar**
Adjunct Faculty
Finance



Subhamitra Patra
Assistant Professor
Finance



Vasanthi Mamidala
Senior Lecturer
Finance



**Vedprakash V
Meshram**
Assistant Professor
Finance



Adlino Afonso
Lecturer
BDA



Alok Tiwari
Assistant Professor
BDA



**Anup Kumar
Maurya**
Associate Professor
BDA



Dnyanesh Khedekar
Lecturer
BDA



Manoj Kumar
Assistant Professor
BDA



P. Balasubramanyam
Associate Professor
BDA



**Soumen Kumar
Manna**
Assistant Professor
BDA



Suman Sanyal
Associate Professor
BDA



Sumit Tripathi
Associate Professor
BDA



Abhishek Naresh

Assistant Professor
General Management
& Public Policy



Anshul Aggarwal

Assistant Professor
General Management
& Public Policy



Chinmaya Behera

Associate Professor
General Management &
Public Policy



Dipankar Das

Assistant Professor
General Management
& Public Policy



Divya Singhal

Professor
General Management
& Public Policy



Joy Chowdhury

Assistant Professor
General Management
& Public Policy



Kingshuk Sarkar

Associate Professor
General Management
& Public Policy



Prakash Singh

Associate Professor
General Management
& Public Policy



Rubaina Shrivastava

Assistant Professor
General Management
& Public Policy



Sebastian Morris

Senior Professor
General Management
& Public Policy



**Swarna
Parameswaran**

Assistant Professor
General Management
& Public Policy



Ajay Vamadevan

Professor
Healthcare Management



**Arif Raza
Mohammad**

Associate Professor
Healthcare Management



**Kheya Graca Noronha
E Melo Furtado**

Associate Professor
Healthcare Management



**Nafisa Vaz E
Desouza**

Assistant Professor
Healthcare Management



Praveen P.A

Associate Professor
Healthcare Management



Shawnn Coutinho

Associate Professor
Healthcare Management



Sreerupa Sengupta

Associate Professor
Healthcare Management

[CLICK HERE TO KNOW MORE ABOUT OUR FACULTY](#)

Academic Advisory Council

CHAIRMAN

▲ Prof. Furqan Qamar

Former Secretary General of AIU

Professor of Management, Centre for Management Studies, Jamia Millia Islamia, New Delhi

MEMBERS

▲ Dr. Ajit Parulekar

Director

Goa Institute of Management

▲ Dr. Parveen Kumar

Director, ICAR Research Complex for
Goa ELA, Goa

▲ Mr. Rajesh K Aithal

Faculty Marketing, IIM Lucknow

▲ Dr. P. Balasubramanyam

PGDM – BDA Chair

Goa Institute of Management

▲ Dr. Sumit Datta

Dean (Administration)

Goa Institute of Management

▲ Prof. NandaKumar Mekoth

FPM – Chair

Goa Institute of Management

▲ Dr. Ajay Vamadevan

PGDM-HCM-Chair

Goa Institute of Management

▲ Dr. Rohit Prabhu Desai

PGP (H) – Chair

Goa Institute of Management

▲ Ms. Jayashri Kulkarni

General Manager, Janssen India and
South Asia (J & J)

▲ Dr. Sebastian Morris

Senior Professor,

Goa Institute of Management

▲ Dr. Manas Mayur

PGP – Chair

Goa Institute of Management

▲ Dr. Venkatesh Naga

Dean (Academics) & Secretary of AAC

Goa Institute of Management

▲ Dr. T. V. Rao

Chairman, TVRLS,

Former Professor - IIMA;

Founder & First President NHRDN

▲ Mr. Paritosh Anand

Senior Vice President & Head - Digital
Platforms, Analytics & Strategic Initiatives at
Reliance Industries

▲ Prof. P. D. Jose

Professor, IIM – Bangalore

▲ Prof. Suman Kundu

Director, BITS Pilani,

K K Birla Goa Campus

▲ Mr. Ketan Hajarnavis

Founder & Managing Director,

ScaleFactor Consulting Labs Pvt. Ltd.,

▲ Dr. N Rajendran

Chief Digital Officer & Addl. Charge of CTO
Multi Commodity Exchange of India

▲ Dr. Prakash Singh

CER – Chair

Goa Institute of Management

▲ Prof. Rakesh Shrivastava

MDP – Chair

Goa Institute of Management

▲ Prof. Abhishek Ranga

PGDM BIFS – Chair

Goa Institute of Management

Board of Governors

CHAIRMAN

- ▲ **Mr. Ashank Desai**
Founder, Mastek Ltd.

SECRETARY

- ▲ **Dr. Ajit Parulekar**
Director, Goa Institute of Management

MEMBERS

- ▲ **Mr. Shivanand V. Salgaocar**
Managing Director
V. M. Salgaocar & Bro. Ltd.
- ▲ **Mr. Dattaraj V. Salgaocar**
Managing Director
V.M. Salgaocar Corp. Pvt. Ltd., Goa
- ▲ **Mr. Arjun Deepak Gadre**
Director
Gadre Marine Export Pvt.Ltd
- ▲ **Ms. Kshama Fernandes**
Managing Director and CEO
IFMR Capital
- ▲ **Dr. Venkatesh Naga**
Dean Academics
Goa Institute of Management
- ▲ **Dr. Divya Singhal**
Faculty
Goa Institute of Management
- ▲ **Mr Nagraj Ijari**
Strategic Advisor – Business & IT
and Executive Coach
- ▲ **Dr. Puneet Kumar Goel, IAS**
Chief Secretary, Government of Goa
- ▲ **Dr. T. V. Rao**
Chairman
T.V.Rao Learning Systems Pvt. Ltd.
- ▲ **Prof Furqan Qamar**
Former Secretary General of AIU)
Professor of Management
Centre for Management Studies
- ▲ **Mr. Sahil Barua**
Managing Director/CEO/Co-Founder
Delhivery Ltd
- ▲ **Ms. Rituparna Chakraborty**
GIM Alumnus
Co-founder and EVP of Team Lease
Team Lease Services Ltd
- ▲ **Dr. Satish Shetye**
Ex-Vice Chancellor
Goa University

The administration of Goa Institute of Management reserves the right to make changes in the requirements for admissions, for continuing in the programs, and for completion of the programs, in the content of courses, the fees charged, the regulations affecting students, or to make any other suitable modifications, without prior notice, should these be deemed necessary in the interest of the students, the institute or the profession. Any dispute will be subject to jurisdiction of the competent courts within the jurisdiction of Panaji only.

The Learning Never Stops



 Sanquelim, Poriem, Sattari Goa-403505

 gim.ac.in

 admissions@gim.ac.in

 Admissions office : 91-832-2366925/769

Connect with us >      